



VDL TIM HAPERT

MAKING A DIFFERENCE **FOR THE WORLD OF TOMORROW**



STRENGTH THROUGH COOPERATION

VDL TIM Hapert

We are an **international** company

Specialized in the mechanical processing of cast- and forging parts and assemblies

We are IATF 16949, ISO 14001 and ISO 3834-2 **certified**

Experienced in procuring raw material from all over the world

Using **reliable** and well-known suppliers

VDL TIM Hapert

Markets



Heavy Truck



Material Handling



Hydraulic Components



Busses

VDL TIM Hapert

Product examples

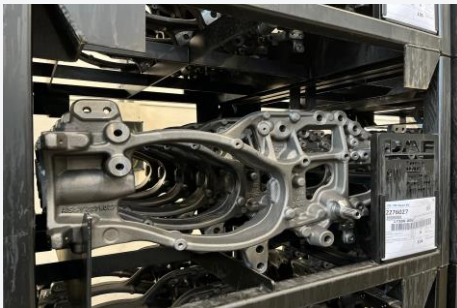

FACTS AND FIGURES 2023

○ — **1971** — ○ — ○

VDL TIM Hapert
was founded in 1971



150

committed employees



33.500

M² production surface area in Hapert



26 subcontractors
across
12 countries
around the world



Turnover
€ 85,4 million



95% export
to
11 countries
around the world

VDL TIM Hapert

Company values

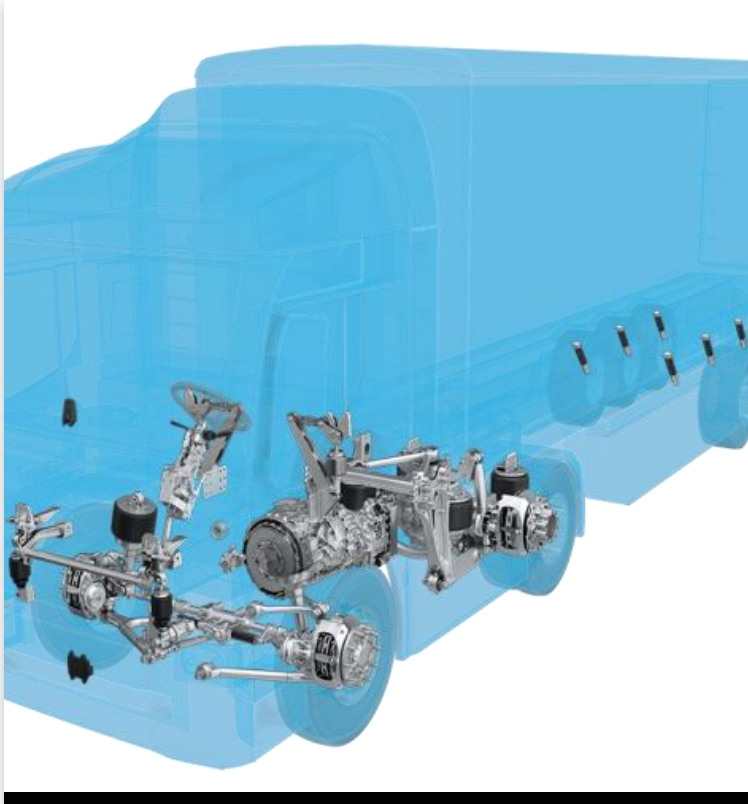

Deliver good and reliable products



Social and sustainable



Safety first

VDL TIM Hapert

Vision

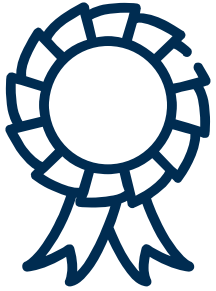

**To be an outstanding
supplier**

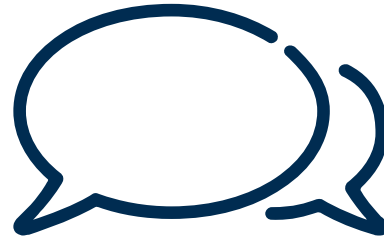

**Open communication and
cooperation**

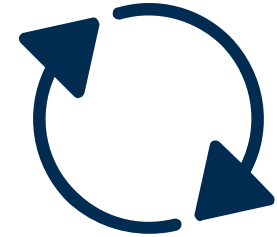

Continuous improvement



Robotized automation



100% customer satisfaction

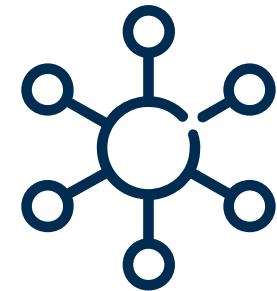

**Diversification in different
industries**

FOUNDRIY REFERENCES

AAPICO Portugal

Fondium

AFC Redon

I.I.W. Thailand

Busch Hungary

Draxton

Castings PLC

Metalpol Poland

Collignon

Metal Smelting SA

Dania

Vald Birn

Demisas

VDL Castings Heerlen

Ferro Dokum

Hundhausen GmbH

Franken Guss

FORGING REFERENCES

A close-up photograph of a forging process. A bright, glowing orange-red metal piece is being shaped by a hammer in a forging press. The metal is in the center, with the hammer head visible above it. The background is dark and industrial.

Cukurova

Forges de Courcelles

Georg Umformtechnik

Hammerwerk Fridingen

Schöneweiss

SW Umformtechnik

VDL TIM Hapert

Certifications



ISO 14001

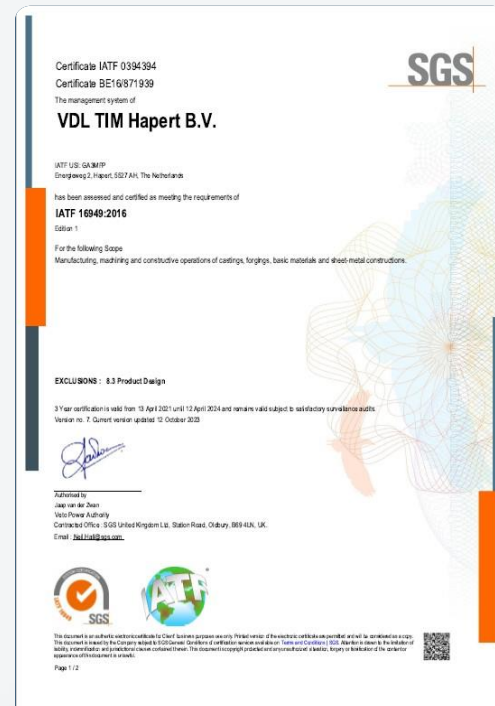

IATF-16949

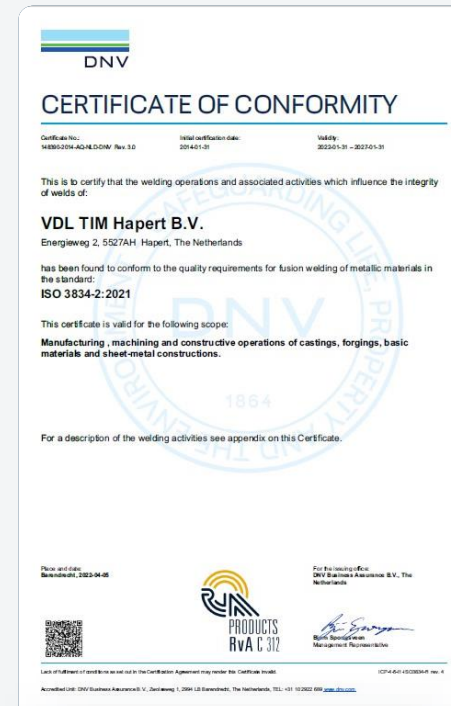

ISO 3834-2

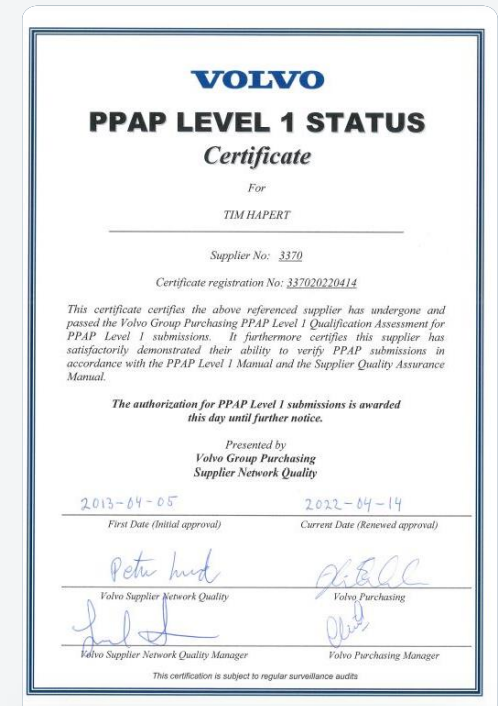

PPAP LEVEL 1

VDL TIM Hapert

New Plant (a.o. Wheelhub production)

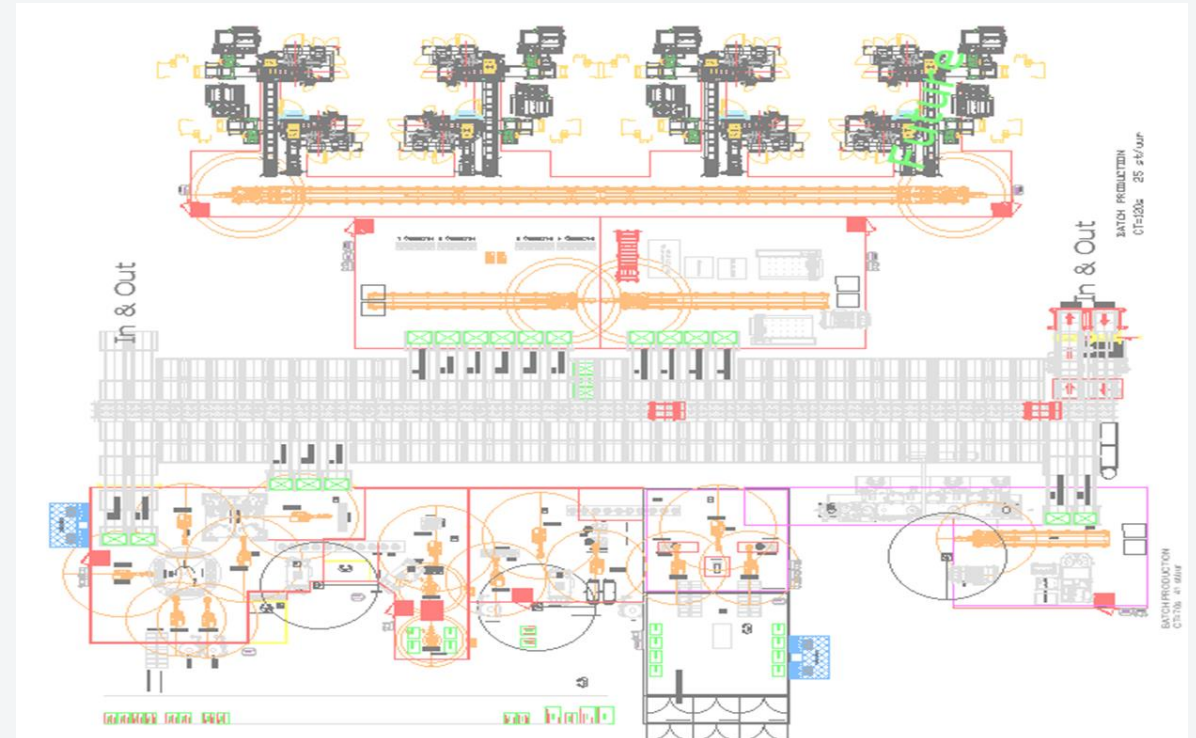
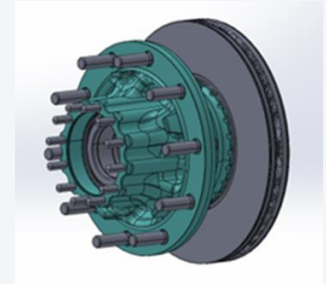
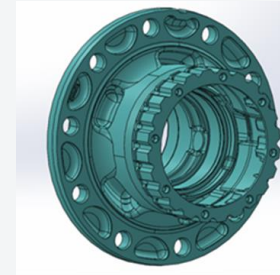
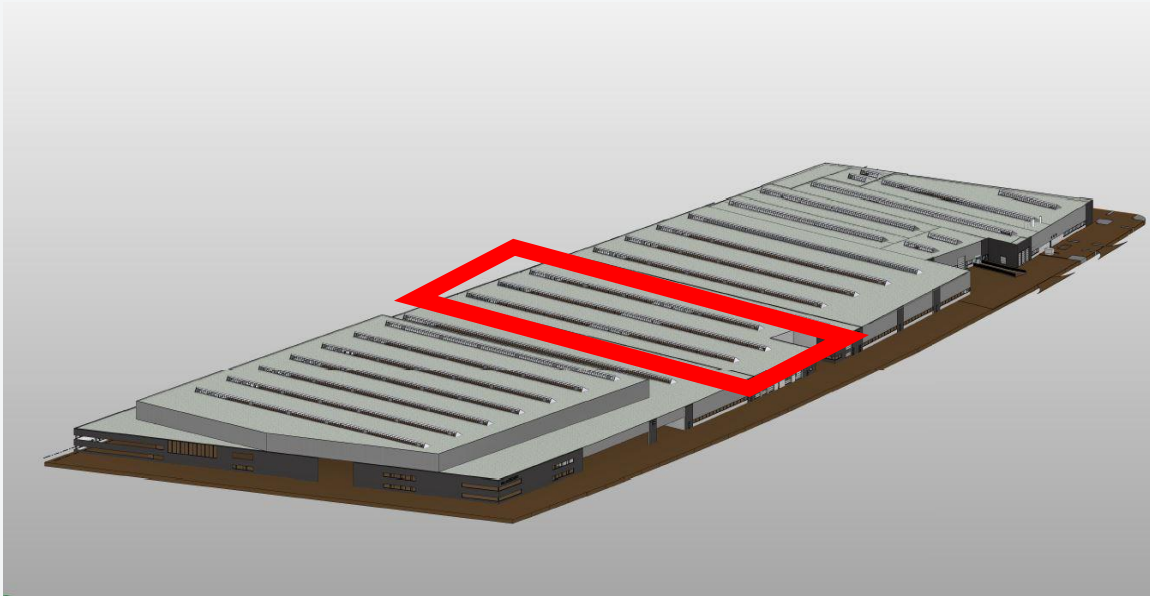

VDL TIM Hapert

New Plant (a.o. Wheelhub production)

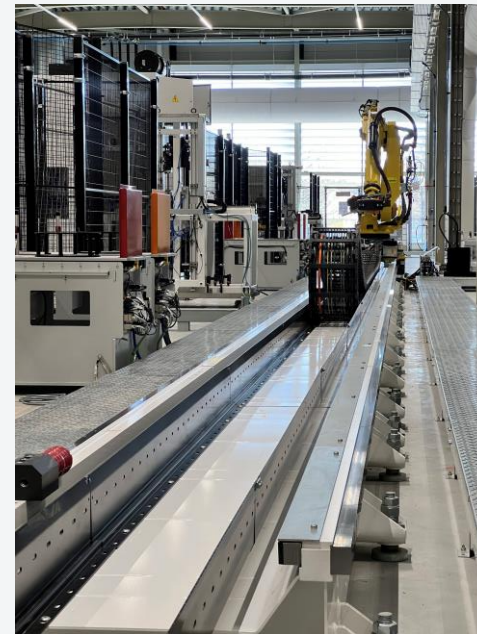
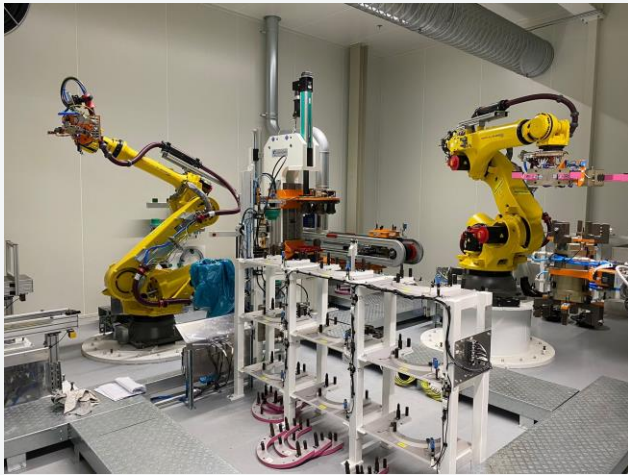

VDL TIM Hapert

New Plant (a.o. Wheelhub production)

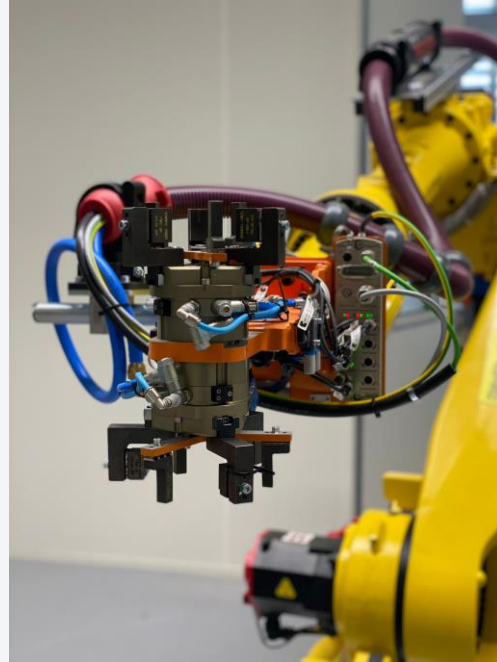



VDL TIM HAPERT

Thank you for your attention



STRENGTH THROUGH COOPERATION